

Xiaolei

Super Smart Switch (6-Gang)



Manual

www.xiaolei.com.cn

Application Diagram

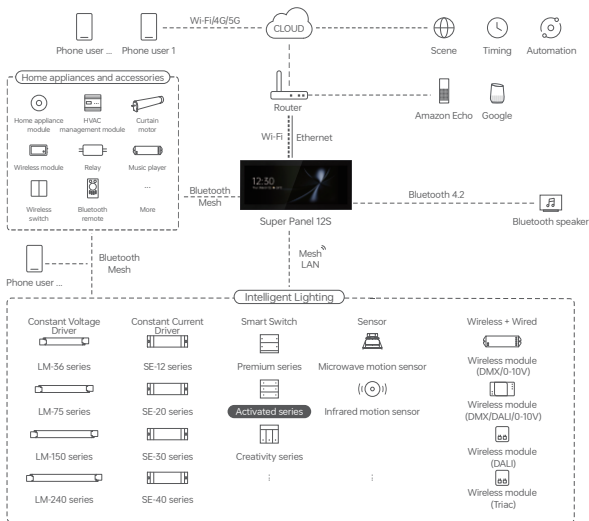

Product Features

- Bluetooth 5.0 SIG Mesh with high networking capacity enables reliable and stable local control.
- Work with a Bluetooth LED driver to turn lights on/off, change brightness and colors.
- Work with a smart gateway to achieve various cloud scenes, cloud-based automation, and local automation.
- Support local scenes that can still run without the Internet or a gateway, faster and more stable.
- Multiple interaction methods. Single press/long press action control supported.
- Support battery check. When the battery on the panel is too low, the indicator light will flash that reminds you to replace the battery.
- Place the back of the switch into any magnetic field or stick it anywhere with a 3M adhesive. 400+ combination options for one row with integrative installation.

Technical Specs

Model	S6-B
Wireless Type	Bluetooth 5.0 SIG Mesh
Power Supply	Battery Powered
Input Voltage	3V  (Button Battery CR2032×2)
Working Temperature	-20°C~55°C
Working Humidity	≤80%RH
Net Weight	75g
Dimensions	86×86×10.5mm (L×W×H)
Colors Available	Grey, Gold, White



Bluetooth®



RoHS

Product Images



Product Size

Unit:mm

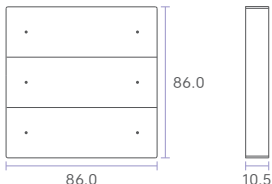

Battery Replacement

Use a flat head screwdriver to remove the back cover of the panel. Replace the batteries with new ones(battery specification: CR2032), and then securely close the back cover.

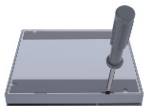

Remove the battery insulation sheets before use.



Installation Methods

Method 1: Simply place the panel directly on the desktop.

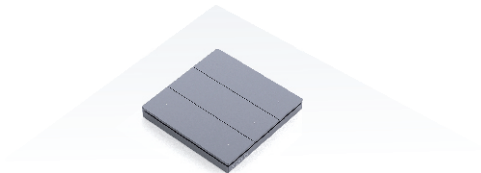

Method 2: Mount the bracket onto the wall either by drilling holes and securing it with KA2.6 screws, or by using the provided 3M tape to stick the bracket to the wall. Finally magnetize the panel to the bracket to complete the installation.

- ① Fix the panel via screws ② Stick it with a 3Mtape



Magnetic bracket

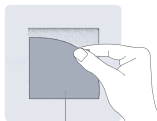

3M tape



Recommended Applications

1. Connect to a Bluetooth LED driver to control the lamp wirelessly.

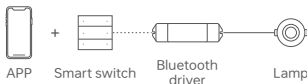

2. Connect to a Bluetooth curtain motor to intelligently open/close curtains.

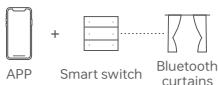

3. Support local scenes that can still run without the Internet or a gateway.

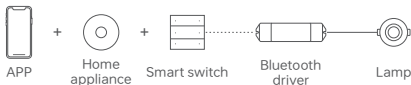

4. Connect to a smart gateway to achieve visual control, cloud scenes, and automated linkage.



5. Intelligent control. Set up more app configs as you like.

App Operating Instructions

1. Register an account

Scan the QR code below with you mobile phone and follow the prompts to complete the app installation. Then open the App and log in or register an account.



2. Connect to the network

Create a home if you are a new App user. Click 【+】 icon in the upper right corner of “Room” interface to access “Add device” page. Pick 【Smart panel】 from the list and follow the on-screen prompts to add the device.

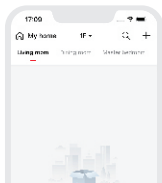

3. Bind devices

On the "Room" interface, click the added smart switch to enter the "Control" interface.

Short-press the corresponding button on the interface, select the binding target [Device], choose the short-press/long-press action, then click the "Save" button. Follow the on-screen prompts to activate the panel, and it will be completed when the interface shows "Saved successfully".

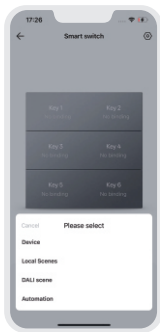
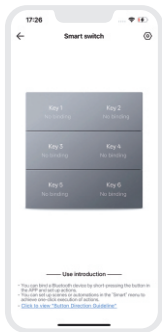

4. Local scene

Create a local scene:

Switch to the **【Smart】** page, click "+" in the upper right corner to create a local scene, and after setting the execution action, you can realize the local linkage of Bluetooth devices.

Binding local scenes:

On the control details page, click on the corresponding key, and set the binding scene. Once saved successfully, a short press of the button will immediately execute the bound scene.

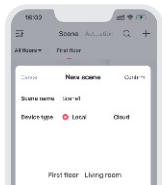

Create a local scene

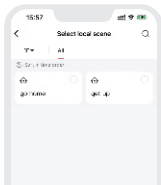

Binding a local scene

5. Cloud scenes and automation

Make sure that a smart gateway, such as Super Panel 12S, has been added to the family.

Cloud scenes:

Switch to the **【Smart】** interface and click “+” to create a cloud scene. After setting the execution action, remote linkage can be achieved.

Automation:

Select “Automation” in the **【Smart】** page and click “+” to create automation. You can choose local/cloud execution mode, and set trigger conditions and execution actions. When the set trigger conditions are met, a series of device actions are automatically triggered to achieve remote linkage.

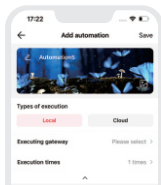
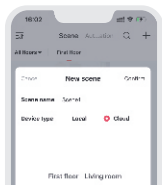

FAQs

1. How to reset a switch to factory defaults?

- Long press any button on the smart switch for 15 seconds until the indicator light flashes fast and release it. Then short press the same button three times within 3 seconds. When the indicator light flashes, the device has been reset to factory defaults.

2. What should I do if I fail to search the device via APP?

- Please make sure the device is powered on normally and is in the activated state.
- Please keep you mobile phone and device as close as possible. The recommended distance between them is no more than 15 meters.
- Please make sure the device hasn't been added yet. If it has, please reset the device to factory defaults manually.

3. Why do the indicator lights of Key 1 and Key 2 flash 5 times during operation?

- It reminds that the battery is low and should be timely replaced.

Attentions

- Product installation and commissioning should be done by a qualified professional.
- LTECH products are and not lightningproof non-waterproof (special models excepted).
- Please avoid the sun and rain. When installed outdoors, please ensure they are mounted in a water proof enclosure or in an area equipped with lightning protection devices .
- Good heat dissipation will prolong the working life of products. Please ensure good ventilation.

- Please check if the working voltage used complies with the parameter requirements of products.
- The diameter of wire used must be able to load the light fixtures you connect and ensure the firm wiring.
- Before you power on products, please make sure all the wiring is correct.
- If a fault occurs, please do not attempt to fix products by yourself. If you have any question, please contact your suppliers.

Warranty Agreement

- Warranty periods from the date of manufacture: 2 years.
- Free repair or replacement services for quality problems are provided within warranty periods.

Warranty exclusions below:

Following conditions are not within the guarantee range of free repairing or replacement services:

- Beyond warranty periods.
 - Any artificial damage caused by high voltage, overload, or improper operations.
 - Products with severe physical damage.
 - Damage caused by natural disasters and force majeure.
 - Warranty labels and barcodes have been damaged.
 - No any contract or invoice signed by LTECH .
1. Repair or replacement provided is the only remedy for customers. LTECH is not liable for any incidental or consequential damage unless it is within the law .
 2. LTECH has the right to amend or adjust the terms of this warranty. The warranty that issues in writing shall prevail.
- * This manual is subject to changes without further notice. Product functions depend on the goods. Please feel free to contact our official distributors if you have any question.