

# Xiaolei

## Super Smart Switch

(1-Gang / 2-Gang / 3-Gang)



### Manual

[www.xiaolei.com.cn](http://www.xiaolei.com.cn)

# System Diagram

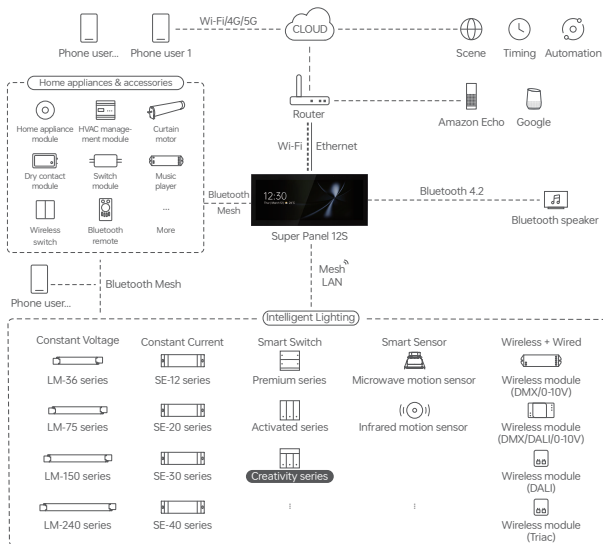

# Product Features

- Customize and show text and icons on the PMOLED display, more intuitive and clear.
- Act as a relay with Bluetooth 5.0 SIG Mesh, turning traditional lamps into smart ones.
- Support panel grouping that allows you to control multiple panels simultaneously.
- Work with a Bluetooth LED driver to turn lights on/off and change brightness or colors of lights.
- Work with a gateway device to achieve various cloud scenes and automation.
- Support local scenes that can still run without the Internet or a gateway. Faster and more stable.
- Designed with 86 type junction box. Available in over 400 panel combinations using the unified panel mounting frames.

# Technical Specs

Model	S1 PRO	S2 PRO	S3 PRO
Wireless Type	Bluetooth 5.0 SIG Mesh		
Power Supply	Null and live line powered		
Rated Parameter	100-240V~, 50/60Hz, μ		
Maximum Current	≤10A		
Single Load	LED≤200W, ⚡ ≤400W		
Channel of Load	1 Channel	2 Channels	3 Channels
Inrush Current in Loads	Max. 65A@2ms		
Working Environment	-20°C~55°C, Humidity≤80%RH		
Net Weight	158g	166g	173g
Dimensions	86×86×40mm (L×W×H)		
Colors Available	Grey, Gold, White		



RoHS

# Product Images

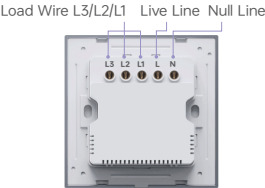

# Product Size

Unit: mm

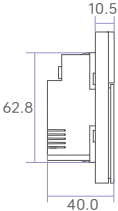
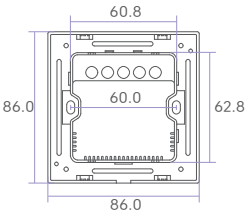

## Installation Steps

- ① Turn off the circuit breaker and remove any concrete or corrosion that are inside the 86 type wall box. Trim each power cord wire in the wall box to about 10cm in length. Pry the switch plate up with a flat head screwdriver.



- ② Attach the live line to L socket of the switch and the null line to N socket, and the load wire to L1/L2/L3 socket. Make sure the wires are well connected to the switch terminals with no copper wire exposed.  
(The protection device for the electronic switch cannot be greater than 35A)

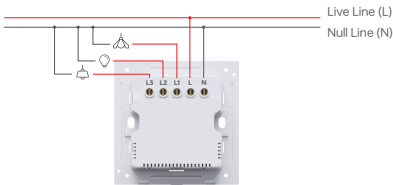

- ③ Insert the screws into the hole on two sides of the switch and secure the screws to fit the switch to the wall with a screwdriver.

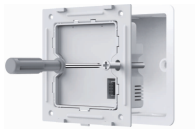

- ④ Slant the switch plate and put it in place. Finally, turn on the circuit breaker and press any key of the switch. If the light can be controlled normally, it means the switch has been installed correctly.



Step 1:  
Snap the switch plate down

Step 2:   
Snap on the switch plate on the bottom

Note: If you want to install multiple panels into one row, please refer to the panel mounting frame manual for detailed instructions.

# Recommended Applications

1. Connect to traditional lamps and turn them into smart ones.

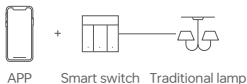

2. Work with a Bluetooth LED driver to wirelessly control lamps.



3. Support local scenes that can still run without the Internet or a gateway.

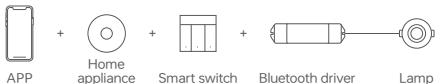

4. Work with a smart gateway to realize visual control and automation.



5. Intelligent control. Set up more app configs as you like.

# App Operating Instructions

## 1. Register an account

Scan the QR code below with you mobile phone and follow the prompts to complete the app installation. Then open the App and log in or register an account.



## 2. Connect to the network

Create a home if you are a new App user. Click 【+】 icon in the upper right corner of “Room” interface to access “Add device” page. Pick 【Smart panel】 from the list and follow the on-screen prompts to add the device.

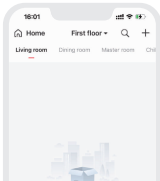



### 3. Create a panel group

Click 【+】 icon in the upper right corner of “Room” interface to access “Add device” page. Pick 【Group-Smart switch group】. Create a smart switch group, then rename the group and set up the room it belongs to. Pick devices you want to add to the group. Once the group is created, the data of sub devices will be synchronized with other switches in this group. So you can control the group devices simultaneously.

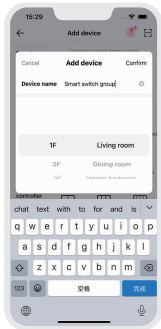

## 4. Relay individual control function

Select "On/off status" at the bottom of the control details page to directly control the relay. In the "Switch Settings" option on the **Settings** page, you can set the relay shortcut card.

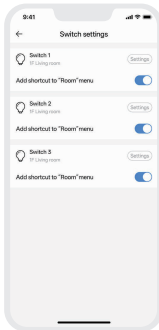
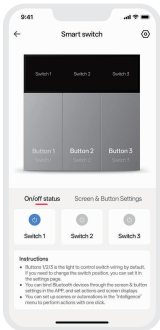

## 5. Device binding and screen display settings

On the control details page, select the screen, click the button to set the bound object and short/long-press action. You can also set the screen display content. Save after setup.

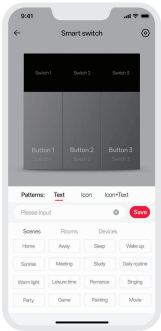
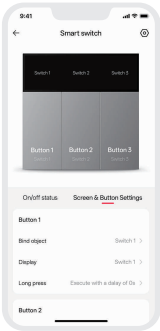

## 6. Adjustment of the switch's default position

On the **【Settings】** page, you can customize the default position of the relay in the "Switch Position" option to achieve personalized device configuration.

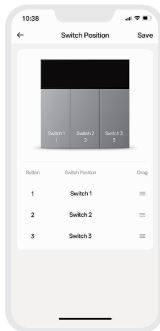
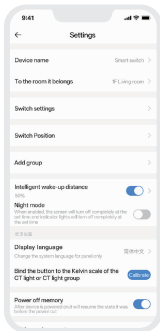

## 7. Intelligent wake-up function

On the 【Settings】 page, turn on the "Intelligent Wake-up Distance" option. The device will automatically wake up when it senses someone within the induction range. You can select from four levels of sensitivity: 25%, 50%, 75%, and 100%.

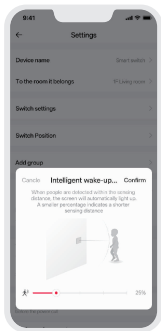
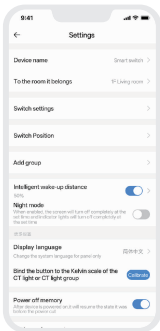

## 8. Local scene

Create a local scene:

Switch to the **【Smart】** page, click "+" in the upper right corner to create a local scene, and after setting the execution action, you can realize the local linkage of Bluetooth devices.

Bind local scenes:

In the [Control] interface, long-press the corresponding button or switch to "Screen & Button Settings", select the binding object [Local Scenarios]. After saving successfully, short-press the smart switch button to execute the bound local scenario.

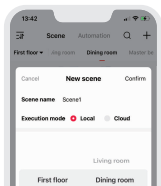

Create a local scene

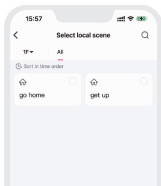

Bind a local scene

## 9. Cloud scenes and automation

Make sure that a smart gateway, such as SP-GW-12S has been added to the family.

Cloud scenes:

Switch to the **【Smart】** interface and click "+" to create a cloud scene. After setting the execution action, remote linkage can be achieved.

Automation:

Select "Automation" in the **【Smart】** page and click "+" to create automation. You can choose local/cloud execution mode, and set trigger conditions and execution actions. When the set trigger conditions are met, a series of device actions are automatically triggered to achieve remote linkage.

Note: Smart switches can be set as trigger conditions or as execution actions.

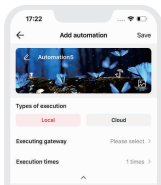
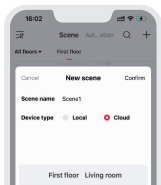

# FAQs

## 1. How to reset a switch to factory defaults?

Long press the rightmost switch button for 15s(S1 PRO=only switch button, S2 PRO=second switch button,S3 PRO=third switch button) and release it until all the indicator lights flash fast. Within 3s,short press the same switch button 3 times and the indicator light flashes slowly, which means the switch has been reset to factory defaults.

## 2. What should I do if I fail to search the device via APP?

Please check below:

- Please make sure the device is powered on normally and is in the activated state.
- Please keep you mobile phone and device as close as possible. The recommended distance between them is no more than 15 meters.
- Please make sure the device hasn't been added yet. If it has, please reset the device to factory defaults manually.

## Attentions

- Product installation and commissioning should be done by a qualified professional.
- LTECH products are and not lightningproof non-waterproof(special models excepted). Please avoid the sun and rain. When installed outdoors, please ensure they are mounted in a water proof enclosure or in an area equipped with lightning protection devices.
- Good heat dissipation will prolong the working life of products. Please ensure good ventilation.
- Please check if the working voltage used complies with the parameter requirements of products.
- The diameter of wire used must be able to load the light fixtures you connect and ensure the firm wiring.
- Before you power on products, please make sure all the wiring is correct in case of incorrect connection that causes damage to light fixtures.
- If a fault occurs, please do not attempt to fix products by yourself. If you have any question, please contact your suppliers.



# Warranty Agreement

- Warranty periods from the date of delivery: 2 years.
- Free repair or replacement services for quality problems are provided within warranty periods.

## Warranty exclusions below:

Following conditions are not within the guarantee range of free repairing or replacement services:

- Beyond warranty periods.
  - Any artificial damage caused by high voltage, overload, or improper operations.
  - Products with severe physical damage.
  - Damage caused by natural disasters and force majeure.
  - Warranty labels and barcodes have been damaged.
  - No any contract signed by LTECH.
1. Repair or replacement provided is the only remedy for customers. LTECH is not liable for any incidental or consequential damage unless it is within the law.
  2. LTECH has the right to amend or adjust the terms of this warranty, and release in written form shall prevail.
- \* This manual is subject to changes without further notice. Product functions depend on the goods. Please feel free to contact our official distributors if you have any question.



[www.xiaolei.com.cn](http://www.xiaolei.com.cn)