

# Switch Module

Model: KMS1



Manual

# Product Introduction

- Fully supports major smart home ecosystems including Apple Home, SmartThings, Google Assistant, and Amazon, enabling unified management across platforms.
- Built-in Thread module, compatible with the Matter protocol, supports Siri, Google, and Alexa voice control.
- Supports OTA firmware updates to continuously receive the latest features and security patches, ensuring long-term device stability.
- Parameter settings for switch type and power-on status can be completed via the NFC Lighting App.
- Reserved mechanical switch/reset switch interface accommodates both traditional operating habits and smart scenario requirements.

## Technical Specs

Model	KMS1
Wireless type	Matter over Thread
Switch channel	1CH
Operating voltage	100-240V~, 50/60Hz, $\mu$
Max. load parameters of the relay	Resistive load: 1000W@230Vac, 500W@110Vac Capacitive load: 400W@230Vac, 200W@110Vac
Relay surge current	70A@10ms
Working temperature	-25°C~50°C
Product size	L45×W45.5×H20.5(mm)
Product weight	38g
Standards	UL 8750、EN 61347-2-13:2014+A1:2017、EN 61347-1:2015+A1:2021、 EN 62493:2015/A1:2022



matter



RoHS



# Product Images

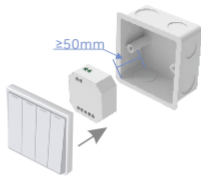
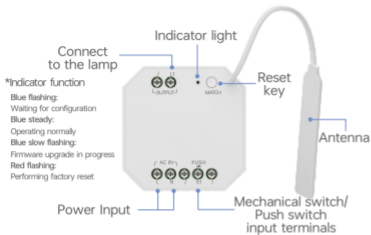

Hide this product inside a junction box.  
\*Requires installation in a box with a depth of  $\geq 50\text{mm}$

# Product Size

Unit: mm

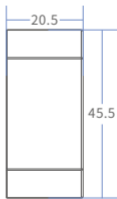
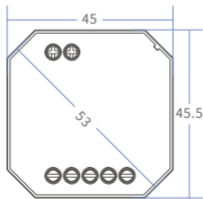

# Wiring Diagram

## 1. Mechanical Switch Wiring Diagram

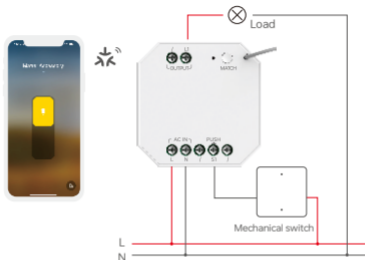

## 2. Push Switch Wiring Diagram

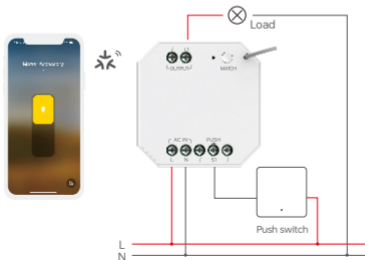

# Use the NFC Lighting APP

Scan the QR code below with your mobile phone and install the APP as prompted.

(Due to performance requirements, the required phone model is Apple: iPhone8 or above, and the operating system iOS13 or above; Android: NFC enabled models).



Scan code download APP  
IOS/Android



NFC sensing area

**\*When setting device parameters,  
Perform this operation only when  
the device is powered off.**

## 1. Read the device

Click "Read/Write LED driver" in the APP [home page], place the sensing area of the phone near the NFC identification point of the driver, and read the device parameters.



## 2. Edit Parameters

Click "Parameter Management" to select the switch type. When selecting a reset switch, you can configure the device's power-on state function.

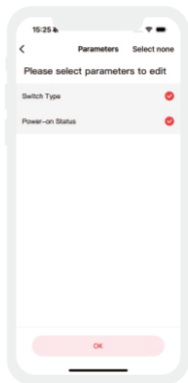
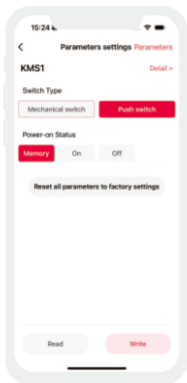

### 3. Add to Matter Platform Instructions

1.This device supports control via major smart home platforms, including Apple Home, Amazon Alexa, Google Home, SmartThings, and others.

2.To connect Matter over Thread devices, you need to prepare a Matter hub supporting Thread border router functionality from major platforms. Refer to the image below for compatible models.

 Apple Home	 Google Home	 Amazon Alexa	 SmartThings
Apple HomePod (second-gen)	Google Nest Hub (2nd Gen)	Amazon Echo (4th-gen)	Aeotec SmartThings Smart Home Hub
Apple HomePod Mini	Google Nest Hub Max	Amazon Echo Hub	Samsung SmartThings Station
Apple TV 4K (2nd gen)	Google Nest Wifi Pro	Amazon Echo Show 8 (3rd-gen)	Samsung SmartThings Hub Dongle
Apple TV 4K (3rd gen,128 GB)	Google TV Streamer (4K)	Amazon Eero 6, Pro 6, 6 Plus, Max 7 etc.	Samsung SmartThings Hub v3

3.This guide uses Apple Home as an example. First, prepare an iPhone (iOS 16.2 or later) or iPad (iPadOS 16.2 or later) with the latest firmware, along with an Apple HomePod mini also running the latest firmware. Then connect your iPhone or iPad to your home Wi-Fi network, launch the Apple Home app, and follow Apple's instructions to set up the HomePod mini.

\*For iPhone models 15 and above, no Matter hub is required; they can be added directly.

## 4. Add accessories

Open the Apple Home app and tap “Add or Scan Accessories.” Add the device to Apple Home by scanning the QR code sticker on the device, as shown below.

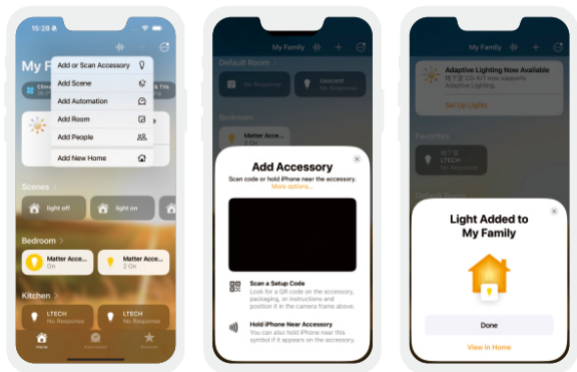

\*You can also activate service via NFC: Simply hold your iPhone 16 or later model near the device's NFC sensor area to be recognized and activated.



## 5. Control device

After successfully adding the device to Apple Home, tap the device icon to turn it on or off.

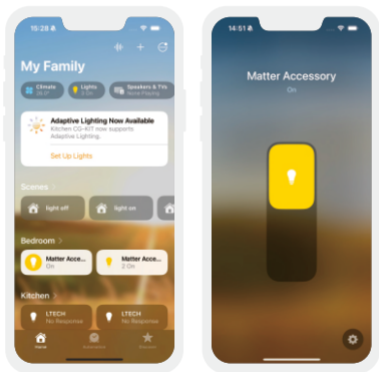

## 6. Advanced Features

Supports creating groups, scenes, and automations, as well as remote control and scheduled control. Devices can also be controlled via Siri voice commands.

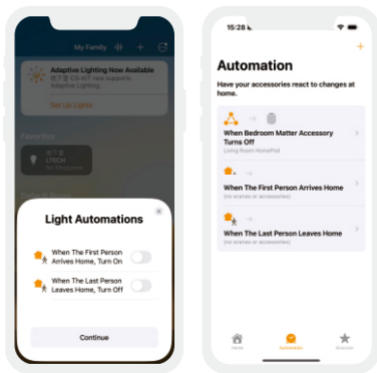

## 7. Restore factory settings

**Reset button reset:** Press and hold the reset button for 15 seconds until the indicator light flashes red rapidly, then release. Within 3 seconds, press the reset button three times briefly. The red light will then switch to slow flashing, indicating the device has begun restoring factory settings. When the indicator light flashes blue rapidly, the restoration is complete.

**Power-on reset:** In the event of a power outage, use the switch to power on the device for 15 seconds before powering it off. Repeat this power cycle six times consecutively (each cycle consisting of 2 seconds on and 5 seconds off). After the seventh power cycle, the load lamp will flash three times, indicating a successful reset to factory settings.

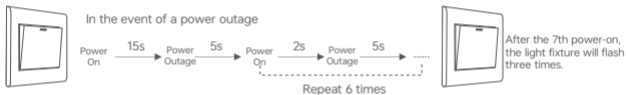

## FAQ

What should I do if the device keeps failing to connect?

Please review the following options:

- Ensure the device is properly powered on;
- Keep the phone and device as close as possible, preferably within 15 meters;
- Ensure the device has not been added before. If it was previously added to an Apple Home, locate the “Matter Accessories” option under “General” in the Apple phone’s settings page.

Find the device in the list, delete it, and manually restore the device to factory settings.

## Attention

- Product installation and commissioning should be done by a qualified professional.
- Our company products are and not lightningproof non-waterproof(special models excepted). Please avoid the sun and rain. When installed outdoors, please ensure they are mounted in a water proof enclosure or in an area equipped with lightning protection devices
- Good heat dissipation will prolong the working life of products. Please ensure good ventilation.
- Please check if the working voltage used complies with the parameter requirements of products.
- The diameter of wire used must be able to load the light fixtures you connect and ensure the firm wiring.
- Before you power on products, please make sure all the wiring is correct in case of incorrect connection that causes damage to light fixtures.
- If a fault occurs, please do not attempt to fix products by yourself. If you have any question, please contact your suppliers.

## Warranty Agreement

- Warranty periods from the date of delivery: 2 years.
- Free repair or replacement services for quality problems are provided within warranty periods.

Warranty exclusions below:

Following conditions are not within the guarantee range of free repairing or replacement services:

- Beyond warranty periods.
  - Any artificial damage caused by high voltage, overload, or improper operations.
  - Products with severe physical damage.
  - Damage caused by natural disasters and force majeure.
  - Warranty labels and barcodes have been damaged.
  - No any contract signed by our company.
1. Repair or replacement provided is the only remedy for customers. Our company is not liable for any incidental or consequential damage unless it is within the law.
  2. Our company has the right to amend or adjust the terms of this warranty, and release in written form shall prevail.
- \* This manual is subject to changes without further notice. Product functions depend on the goods. Please feel free to contact our official distributors if you have any question.