

Xiaolei

Wireless Module

Model: CG-DAM-PRO

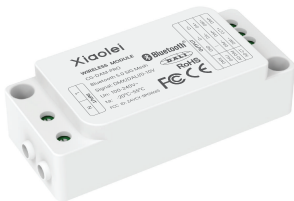

Manual

www.xiaolei.com.cn

Application Diagram

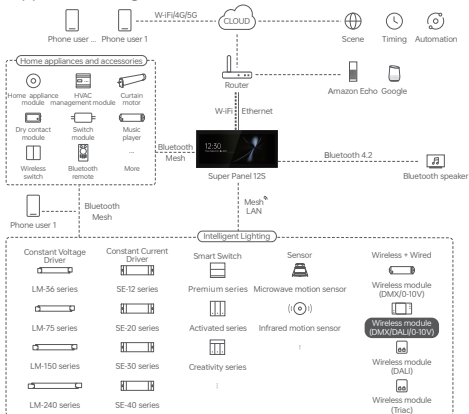

Product Features

- Small size and light weight. Housing made from SAMSUNG/COVESTRO's V0 flame retardant PC materials.
- Bluetooth 5.0 SIG Mesh with high networking capacity provides reliable and stable performance.
- Combine DMX, DALI, 0-10V output into one output port.
- DALI bus power supply.
- Compatible with DIM, CT, RGB, RGBW, RGBCW lights and control their outputs (0-10V outputs are available only in DIM and CT lights).
- Support OTA update and remain ultra-low power consumption; continuously power it on and off to reset it to factory defaults.
- Set the fade time and lighting status.
- CT lights support circadian lighting. Mimic daylight changes, customize the circadian lighting curve and execution time period to fit lighting needs under different environments.
- Support local scenes that can run without the Internet or a gateway. It is faster and more stable.
- Work with a smart gateway to achieve a variety of cloud scenes, cloud-based automation and local automation.
- Suitable for projects that need a large amount of light fixtures, like villas, hotels, supermarkets, etc.

Technical Specs

Model	CG-DAM-PRO
Wireless Protocol Type	Bluetooth 5.0 SIG Mesh
Output Signal	DMX / DALI / 0-10V
Working Voltage	100-240V~
DALI Output	12V \equiv (Max.90mA)
0-10V Output	10V \equiv (Max.15mA)
Working Temperature	-20°C~55°C
Product Size(L×W×H)	84×35×23(mm)
Package Size(L×W×H)	100×70×42(mm)
Weight (G.W.)	30g



Bluetooth®



RoHS



Product Images



Product Size

Unit: mm

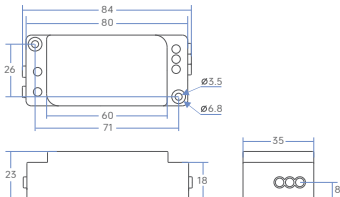

Wiring Diagram

Please confirm the output signal before you begin wiring(Default output signal is DMX). If you need to change the output signal type, please connect the device to the network first using the APP, then switch to the desired output signal (refer to Page 7 for details), and finally start your wire connection.

DMX

Null line(N)

Live line(L)

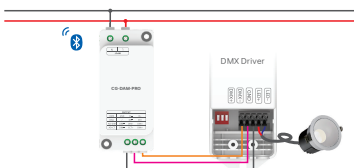

DALI

Null line(N)

Live line(L)

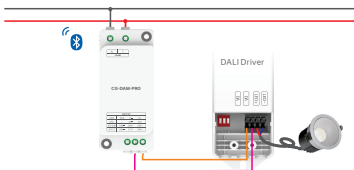

* This module has the integrated DALI bus power supply.

0-10V(DIM)

Null line(N)
Live line(L)

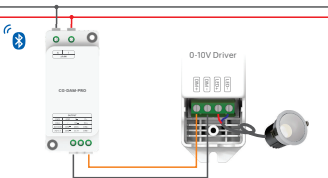

0-10V(CT)

Null line(N)
Live line(L)

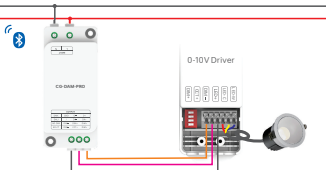

Applications

1. Wireless lamp control.

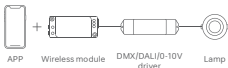

2. After linking the remote controller with the wireless module via the App, you can control the device using the remote controller or App.

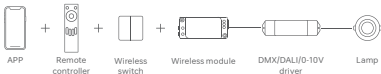

3. Support local scenes that can run without the Internet or a gateway.

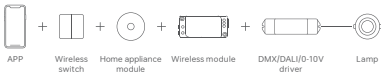

4. Work with a smart gateway to achieve a variety of cloud scenes, cloud-based automation and local automation.



5. More applications of intelligent control are waiting for you to set up.

App Operating Instructions

1. Register an account

1.1 Scan the QR code below with you mobile phone and follow the prompts to complete the app installation.

1.2 Open the App and log in or register an account.



Scan and download the L-Home App

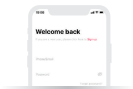

2. Pairing instructions

Create a home if you are a new user. Click "+" icon in the upper right corner to access the "Add device" page. Select "DMX/DALI/0-10V module" and follow the prompts to click "Search via Bluetooth". After the device is found, you can set the output signal (Default is DMX signal) and the light fixture type, then save your settings.



3. Light groups

To ensure the consistency of dynamic effects, you can group together the lights that output the same signal. Once you create the group, you can set the dim level and adjust color temperature, and color of lights more easily. Tap "Group" from the list and follow the prompts to rename the group. Then click "Next" to pick the lights you are going to group together and click "Save".

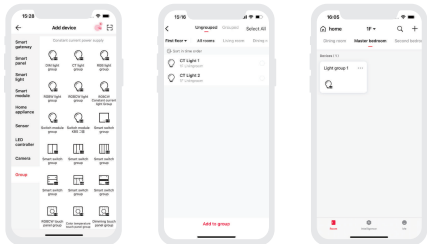

4. Control interface settings

After pairing your device, go to the control interface. You'll be able to achieve your desired lighting effects by changing brightness, colors and color temperature. Click "Theme" and you'll easily switch between various theme lighting effects with one tap. Click "Mode" and the App provides you editable advanced modes. Customize dynamic modes to put you into a more colorful life.

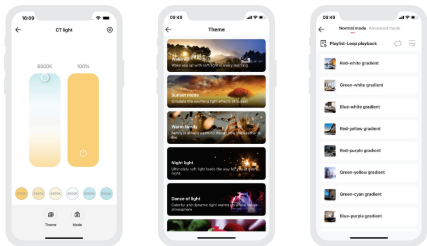

5. Advanced functions

5.1 Control the Wireless module locally by linking it with a local scene.

5.2 Add a smart gateway like Super Panel 12S to achieve a variety of cloud scenes, cloud-based automation and local automation. For details, please view the instructions in the APP.

FAQs

1. What should I do if I fail to search the device via APP?

Please check below:

- 1.1 Please make sure the device is powered on normally and is in the activated state.
- 1.2 Please keep you mobile phone and device as close as possible. The recommended distance between them is no more than 15 meters.
- 1.3 Please make sure the device hasn't been added yet. If it has, please reset the device to factory defaults manually.

2.How to reset the device to factory defaults?

Make sure the Bluetooth wireless module is connected to a lamp and the lamp remains on. Use the switch to power it off. After 5s, power it on. After 2s, power it off again. Repeat the same operation 6 times. When the lamp flashes 5 times , reset the module to factory defaults successfully.

Attentions

- Product installation and commissioning should be done by a qualified professional.
- LITECH products are and not lightningproof non-waterproof (special models excepted).
- Please avoid the sun and rain. When installed outdoors, please ensure they are mounted in a water proof enclosure or in an area equipped with lightning protection devices .
- Good heat dissipation will prolong the working life of products. Please ensure good ventilation.
- Please check if the working voltage used complies with the parameter requirements of products.
- The diameter of wire used must be able to load the light fixtures you connect and ensure the firm wiring.
- Before you power on products, please make sure all the wiring is correct in case of incorrect connection that causes damage to light fixtures.
- If a fault occurs, please do not attempt to fix products by yourself. If you have any question, please contact your suppliers.

Warranty Agreement

Warranty periods from the date of manufacture: 5 years.

Free repair or replacement services for quality problems are provided within warranty periods. Following conditions are not within the guarantee range of free repairing or replacement services:

- Beyond warranty periods.
- Any artificial damage caused by high voltage, overload, or improper operations.
- Products with severe physical damage.
- Damage caused by natural disasters and force majeure.
- Warranty labels and barcodes have been damaged.
- No any contract or invoice signed by LTECH.

1.Repair or replacement provided is the only remedy for customers. LTECH is not liable for any incidental or consequential damage unless it is within the law.

2.LTECH has the right to amend or adjust the terms of this warranty. The warranty that issues in writting shall prevail.

* This manual is subject to changes without further notice. Product functions depend on the goods. Please feel free to contact our official distributors if you have any question.